



Soma Radon

Soma Radon is a high-performance barrier against radon gas, made from a multilayer structure that includes reinforced fiberglass, aluminium foil, bituminous compound, polyethylene top layer, and self-adhesive lateral strips for sealing.

The aluminium layer provides excellent gas impermeability, while the reinforced composition ensures mechanical strength, durability, and stability even under demanding installation conditions. **Soma Radon** complies with EN 13859-1, and carries the CE mark.



Application

Soma Radon is intended as a radon gas barrier beneath concrete slabs, foundations, retaining walls, and other construction elements requiring protection from ground-sourced gas infiltration. Proper installation of Soma Radon helps maintain healthy indoor air quality and ensures compliance with regulations regarding radon protection in buildings. The special double-adhesive strip system allows the membrane to be sealed without the need for additional accessories.

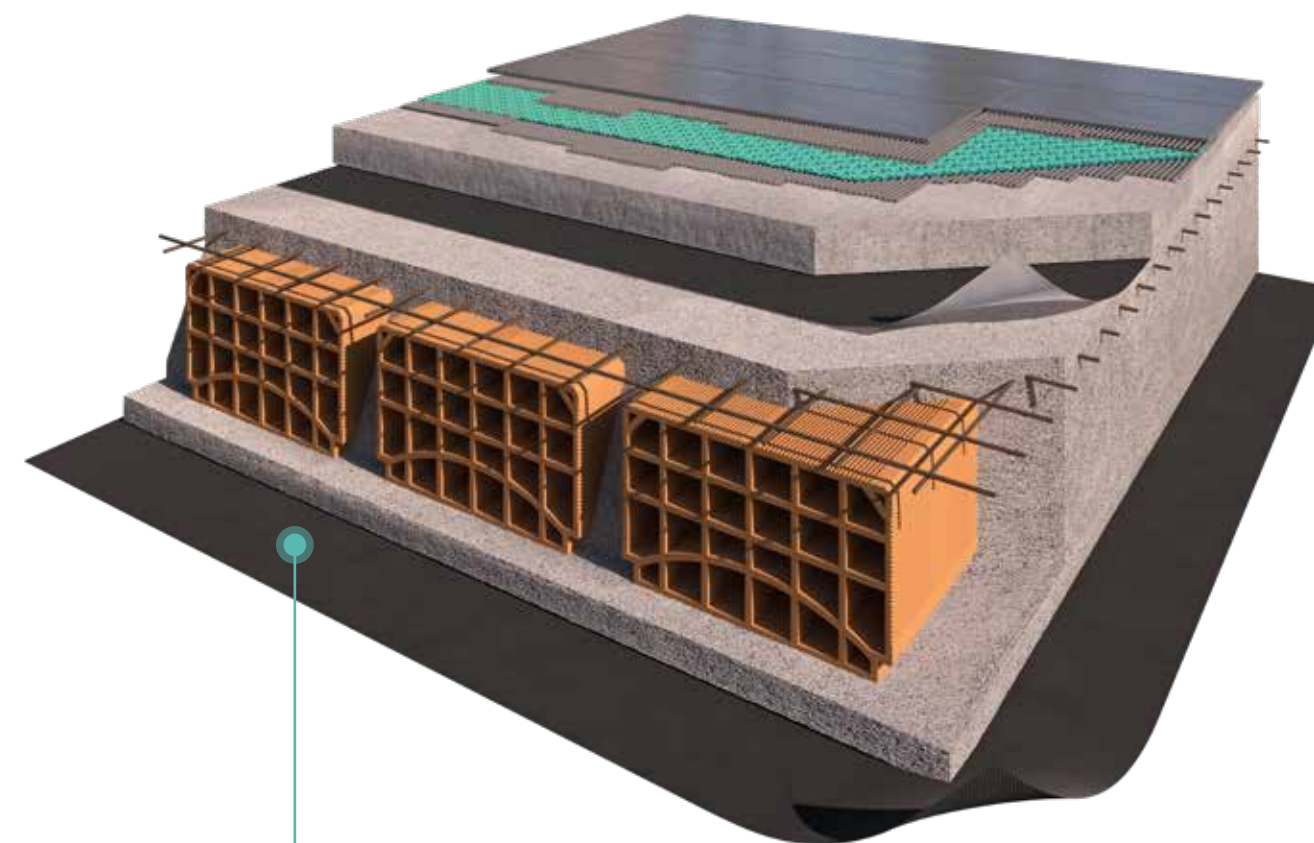

Soma Radon

Features



Rolls per pallet 80x120	Roll Length	Roll Width	Roll Weight	Tensile Strength	Tear Resistance	Radon Permeability
24	30 m	1 m	30 kg	MD: 750±15% N/5cm CD: 330±15% N/5cm	MD: 50±15% N CD: 80±15% N	< 1 cm ³ /m ² x24h x atm (high barrier)

Composition

- Polyethylene Film + Self-Adhesive Bituminous Strip
- Bituminous Compound
- Aluminum Foil
- Fiberglass Nonwoven Fabric
- Bituminous Compound
- Polyethylene Film + Self-Adhesive Bituminous Strip

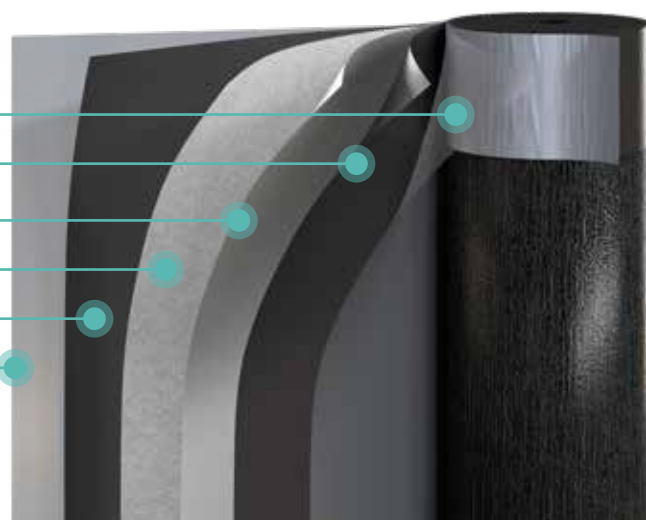

Prodotto	Lunghezza	Larghezza	Tipologia Adesivo
 PLENA BUTYL TAPE	15 m	50 mm	butyl rubber

Product Catalogue